

Assembling the TOPAZ OCR

This procedure describes how to connect video and power cables, and attach the touchscreen display to TOPAZ. Before you begin:

- Read this procedure before you set up TOPAZ
- Determine where you are going to set up and use TOPAZ
- Make sure you have a clean, flat, sturdy surface to assemble TOPAZ
- A fully assembled TOPAZ weighs approximately 46 lbs. / 21 kg. Use caution when unpacking and lifting TOPAZ and the touchscreen. **Get assistance if you need help lifting and holding the display.**
- Familiarize yourself with the touchscreen video and power connectors
- No tools are needed to assemble TOPAZ

Setting Up TOPAZ

CAUTION: The TOPAZ is heavy. Get assistance if you need help moving it.

Step 1. Unpack TOPAZ and place it on a flat, sturdy surface.

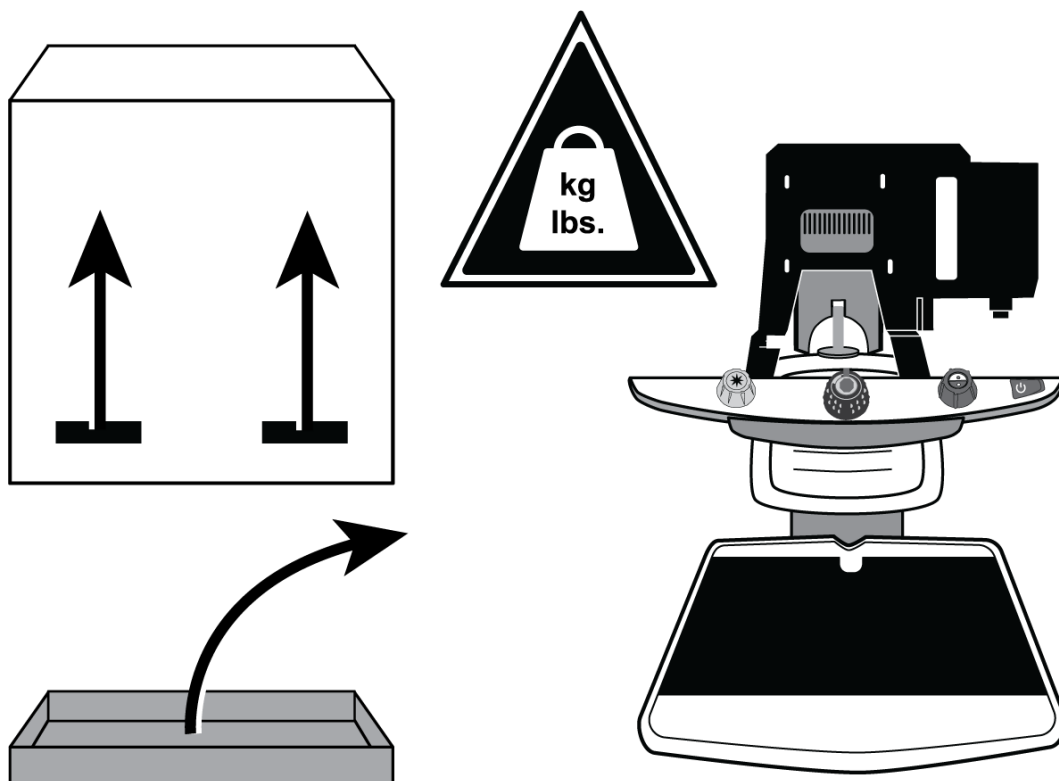

Step 2.

The monitor arm has three cables: HDMI, USB, and LED Flash.

Place the cables through the large opening in the monitor bracket (1).

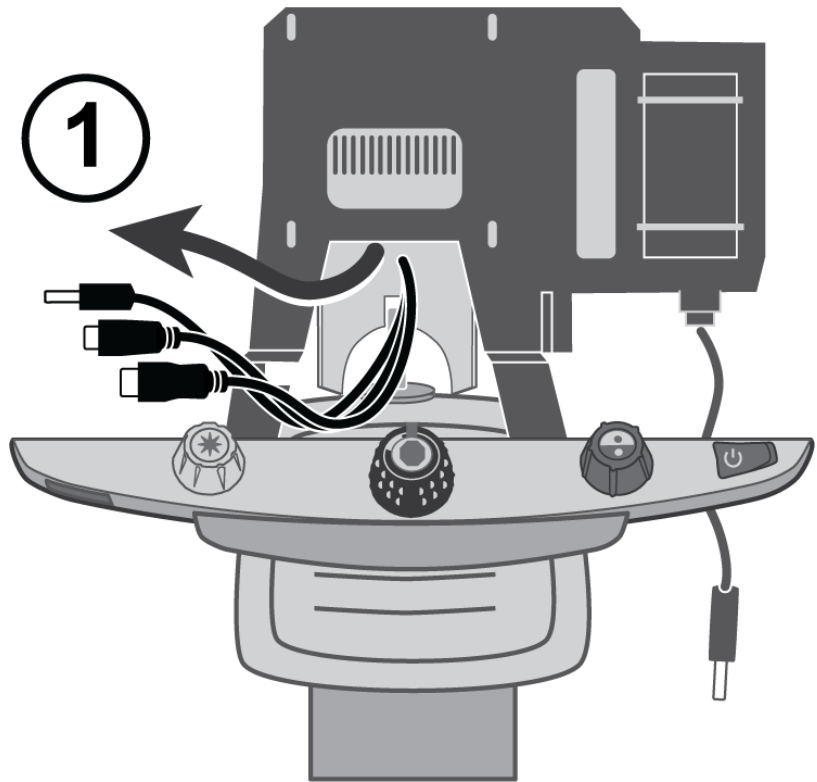

Step 3.

Place the 12V DC power cable (2) across TOPAZ so that it rests between the control panel and the monitor bracket (with the other cables).

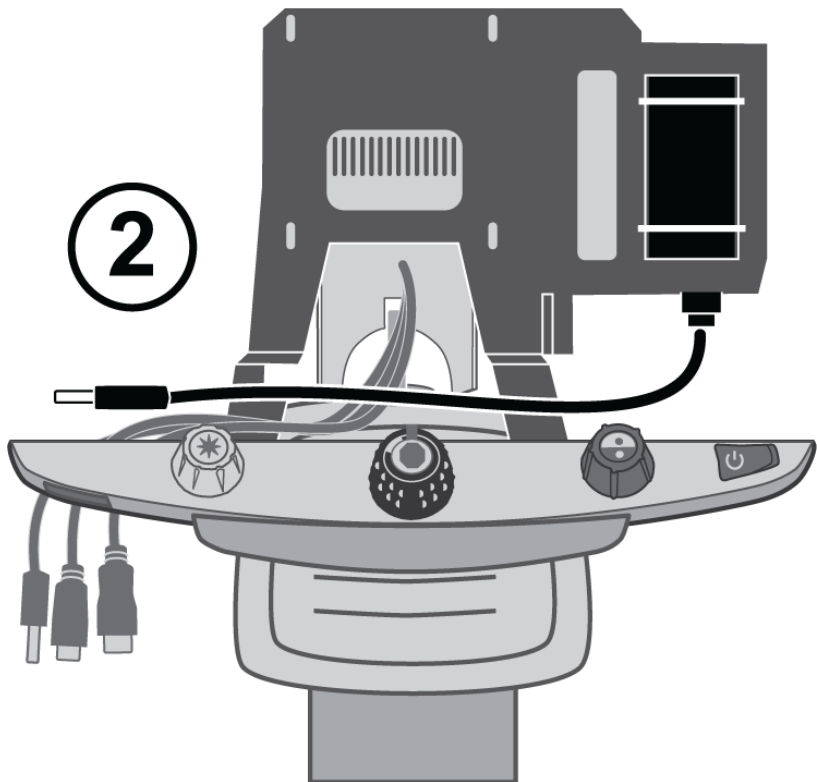

Setting Up the Touchscreen Display

CAUTION: The touchscreen display is heavy. Get assistance if you need help moving it.

Step 1.

Unpack the display and place it face down on a clean flat, sturdy surface.

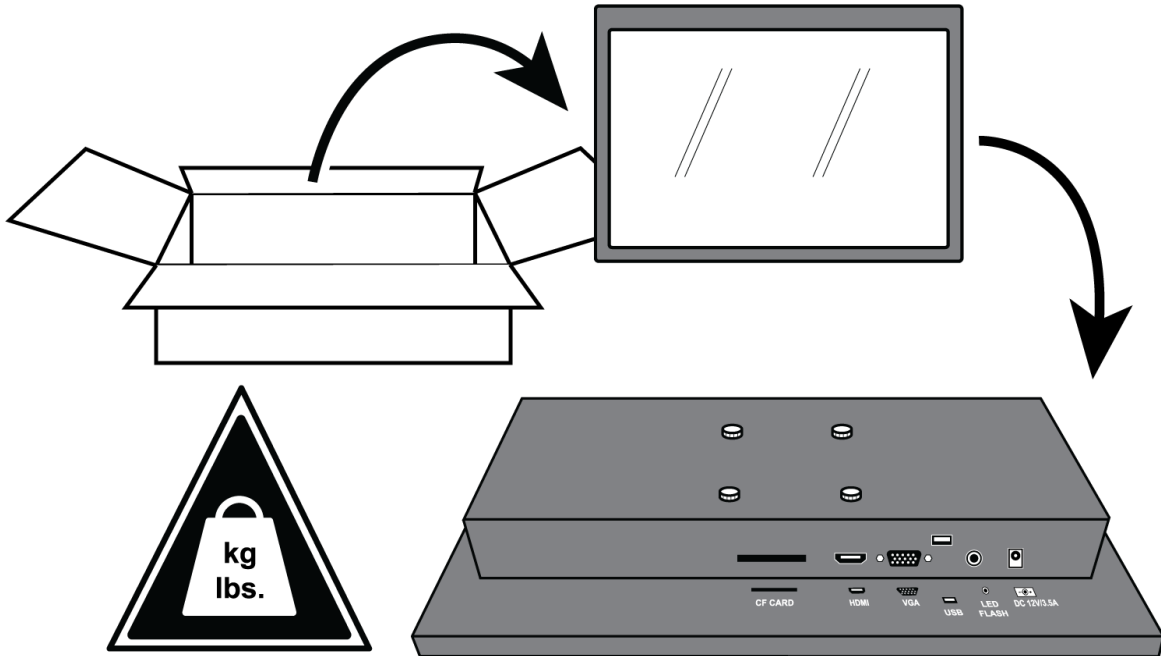

Step 2.

Remove the four thumbscrews from the back of the display, and set them on the TOPAZ XY table.

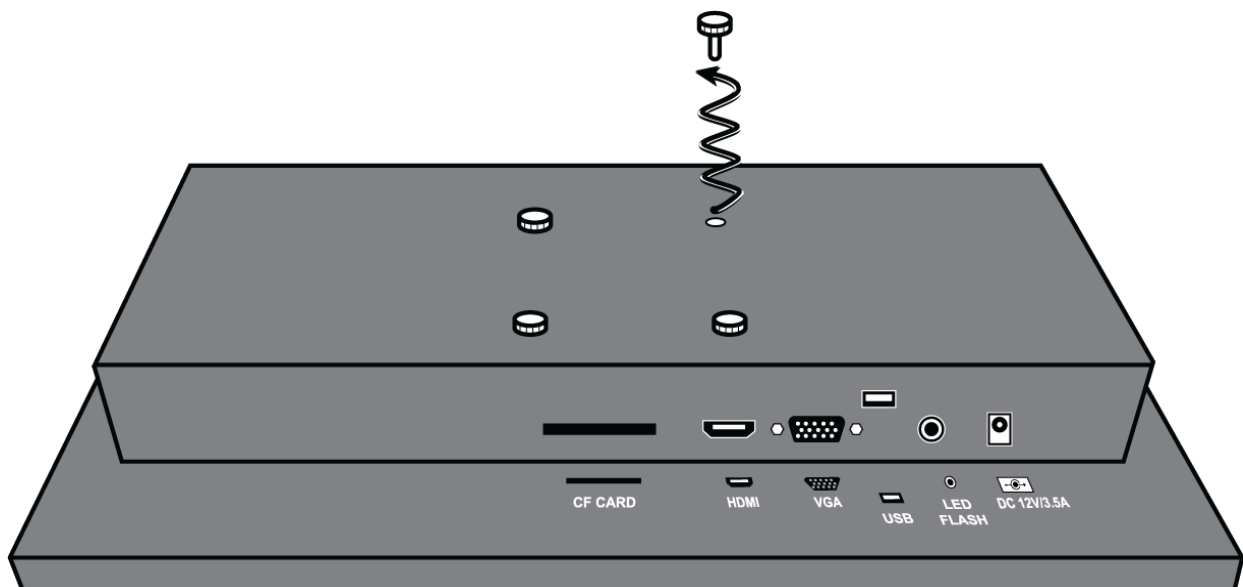

Step 3.

The display's video and power connectors are on the bottom of the display.

Familiarize yourself with the location of these connectors. This will be helpful when later connecting video and power cables.

- HDMI connector (1)
- USB connector (2)
- LED Flash connector (3)
- 12V DC power connector (4)

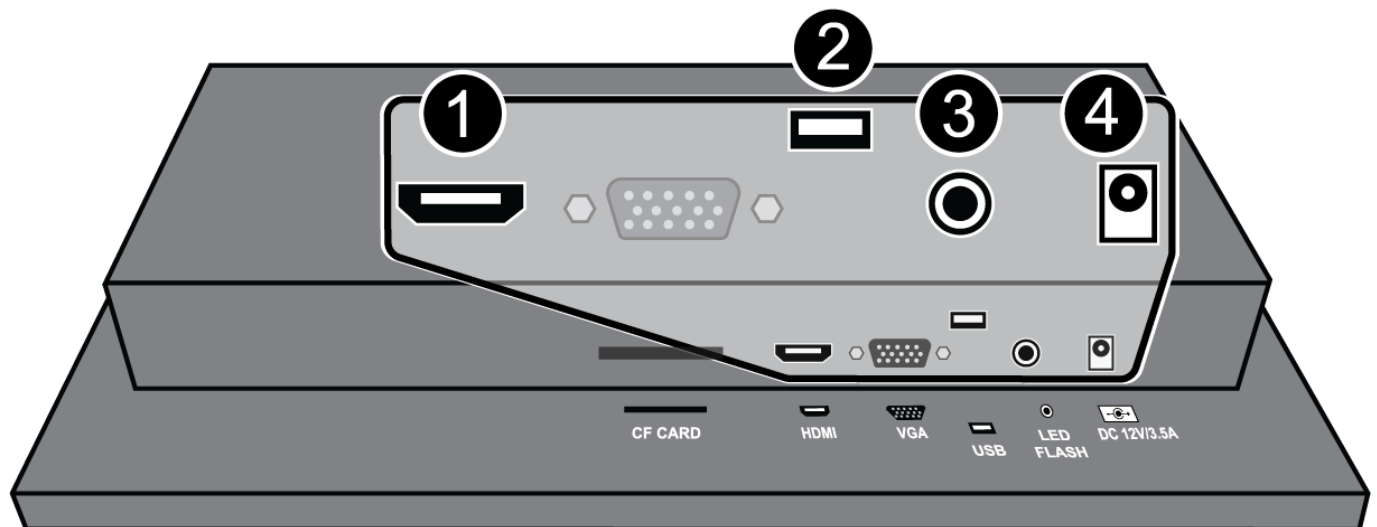

Connecting Cables and Securing the Touchscreen Display

Important: Make sure the video and power cables are out of the way before placing the display on the control panel.

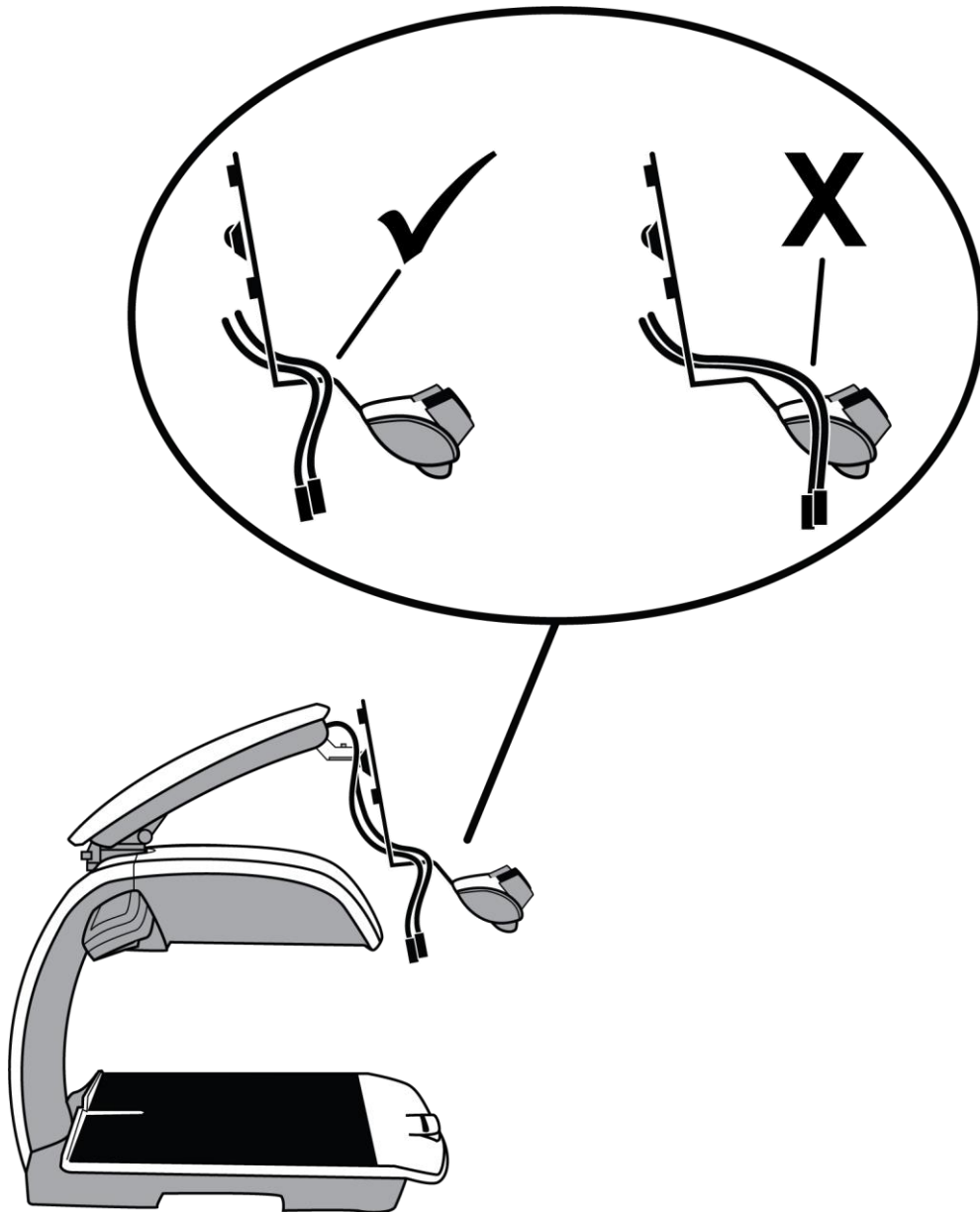

CAUTION:

The display is heavy.
Get assistance if you
need help lifting and
holding it in place.

Step 1.

Pick up the display so
that it is facing you, and
then place its bottom
edge on the top of the
control panel.

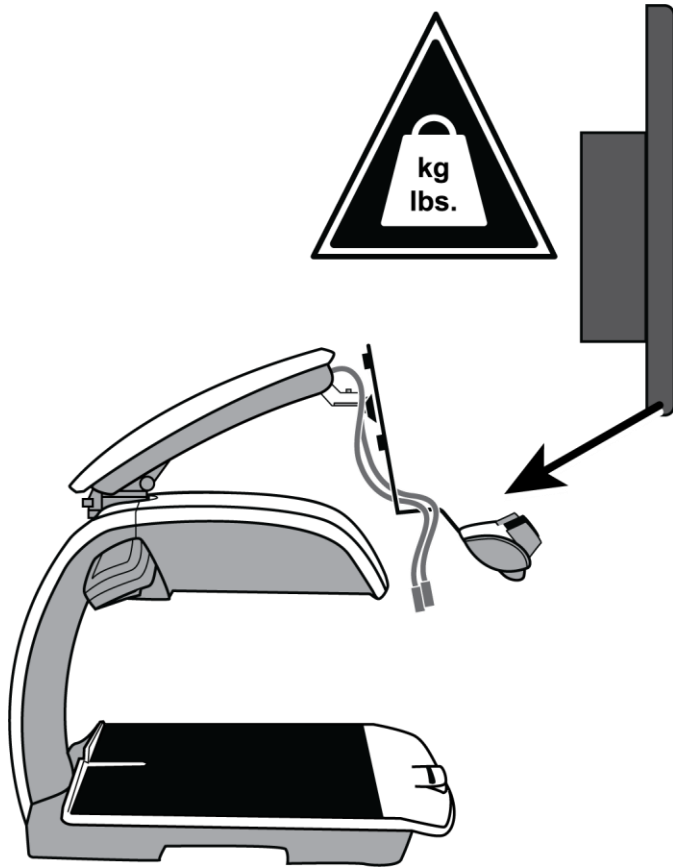
**Step 2.**

While holding the top of
the display, carefully
pivot it toward you so
that the screen is facing
down

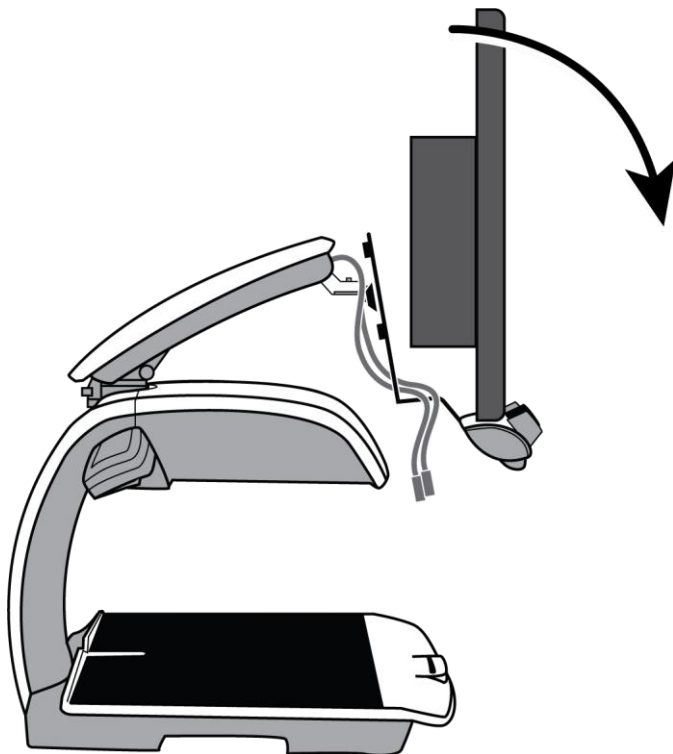

Step 3.

With the display resting on the control panel, connect the following cables to the connectors on the **bottom** of the display:

- HDMI cable (1)
- USB cable (2)
- LED Flash cable (3)
- 12V DC power cable (4)

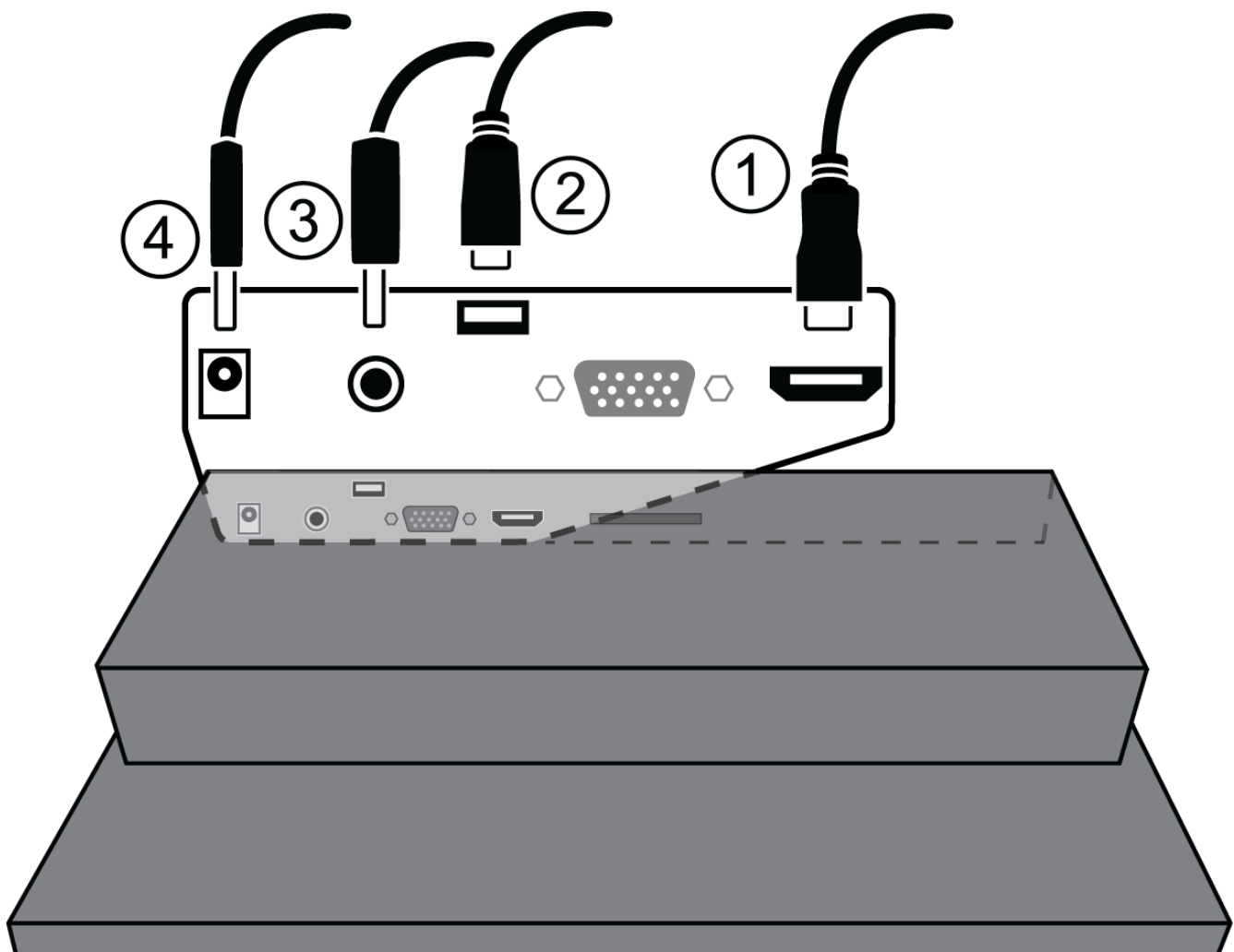
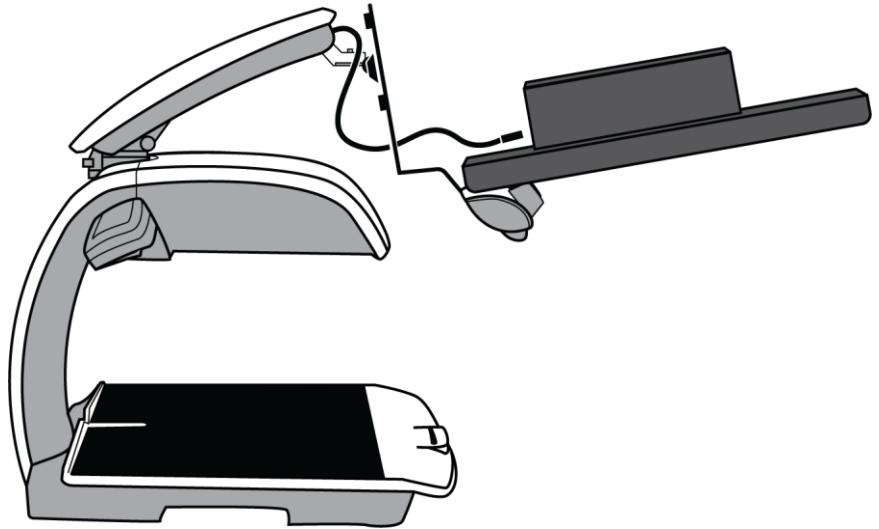

Step 4.

Carefully pivot and raise the display (1) so that its back is resting against the monitor bracket and its bottom is resting on the control panel (2).

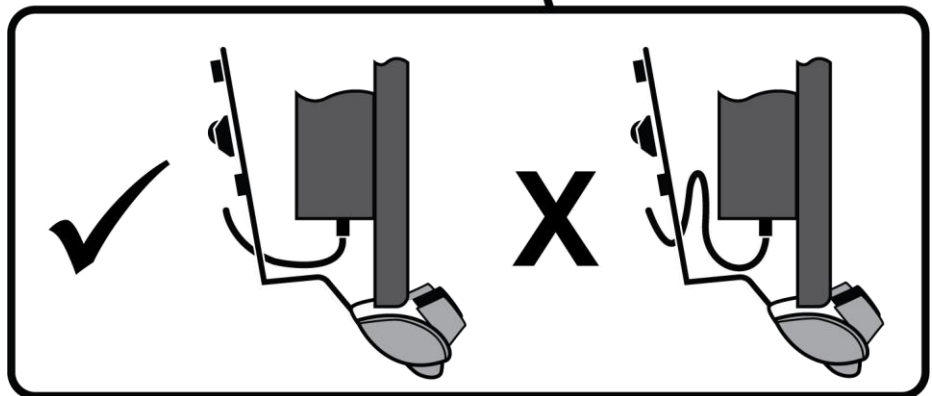
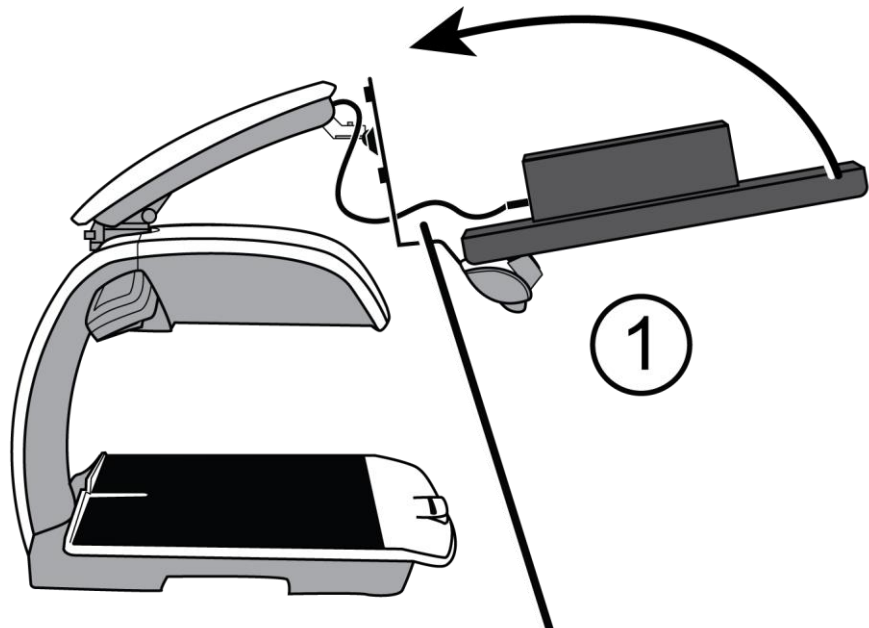

Important: Make sure the video and power cables are clear and not squeezed between the back of the display and the bracket.

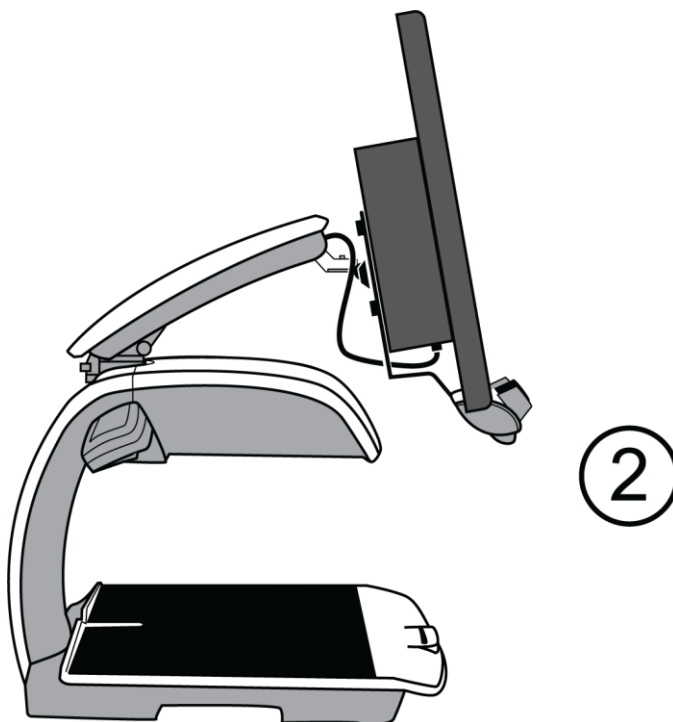

Step 5.

While bracing the display, secure it to the bracket using the four thumbscrews that you removed and placed on the XY table.

Insert the four thumbscrews through the screw slots on the bracket and the screw holes on the back of the display.

Tighten the four thumbscrews.

This completes assembly of the TOPAZ OCR.

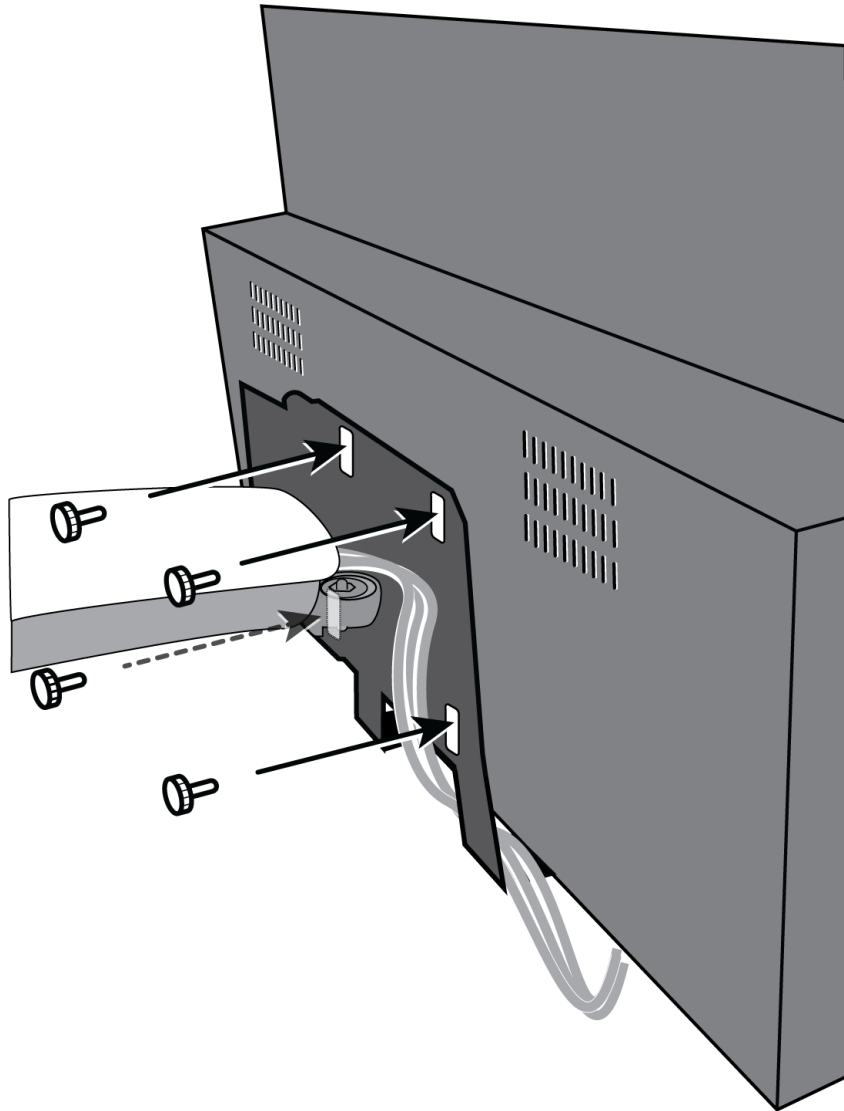

Turning On TOPAZ

Step 1.

Plug the power cord from the middle power connector on the rear of TOPAZ to an electrical wall outlet.

Step 2.

Press the main power switch to the ON position. It is located near the LED reading light on the right side of TOPAZ.

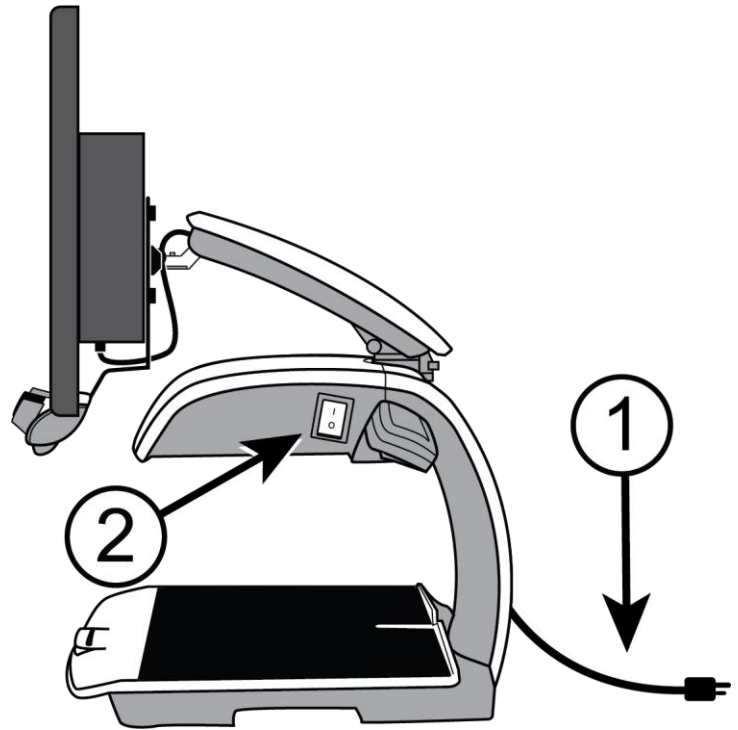

Step 3.

Press the green standby power switch on the right side of the control panel.

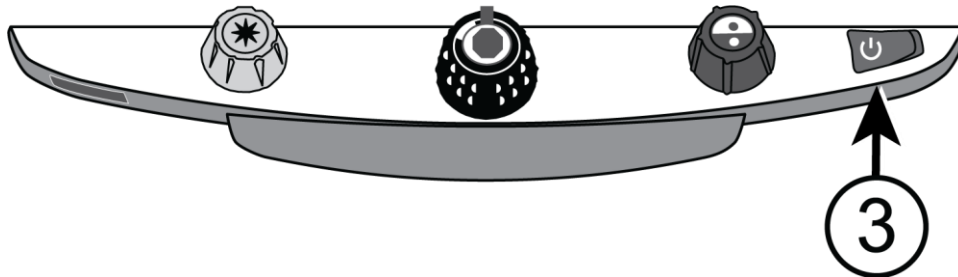

For more information about using TOPAZ, refer to the TOPAZ OCR User Guide.